

# isorock® Technical data

isorock®

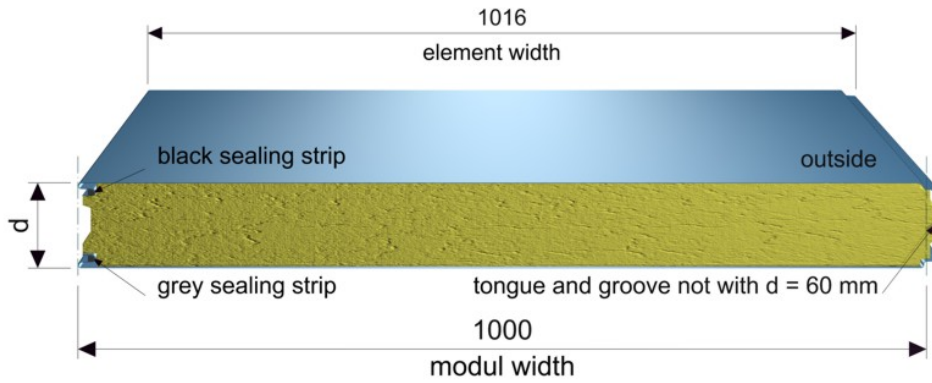

isorock®

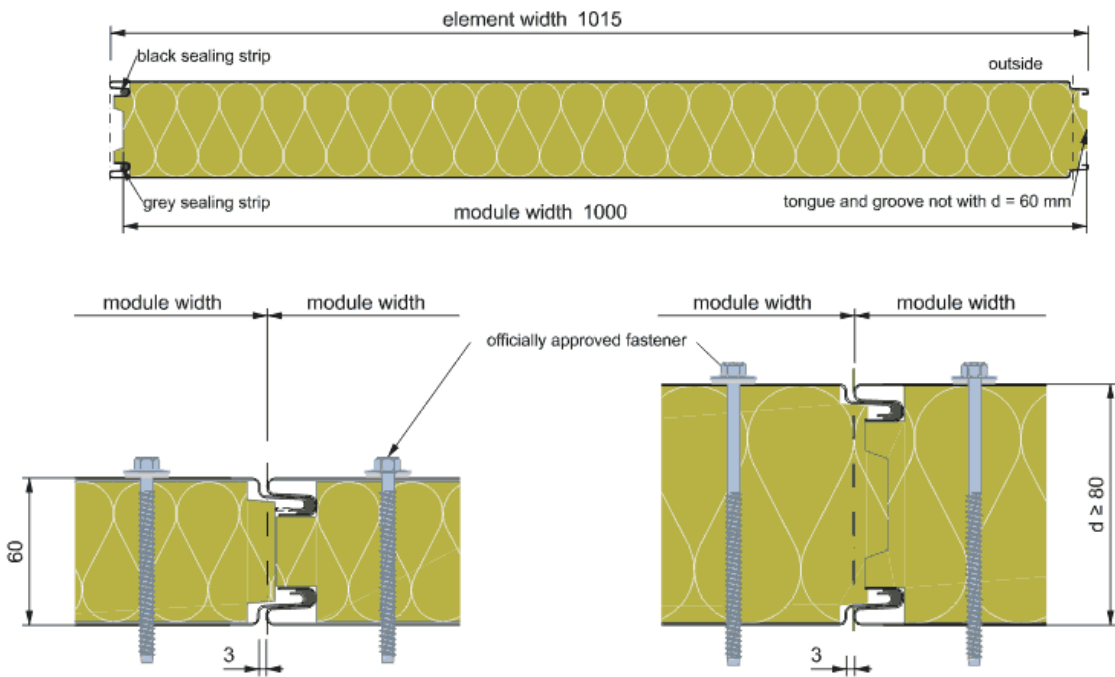

Typ	Element thickness	Material thickness		Max. length supplied	Weight	Thermal resistance	Heat transfer coefficient	Thermal resistance	Heat transfer coefficient
		outer sheet	inner sheet						
	d mm	t <sub>N</sub> mm	t <sub>N</sub> mm	m	g kg/m <sup>2</sup>	R* m <sup>2</sup> K/W	U* W/m <sup>2</sup> K	R <sub>D</sub> ** m <sup>2</sup> K/W	U** W/m <sup>2</sup> K
D1	60	0,50	0,50	16,0	14,6	1,37	0,65	1,35	0,67
		0,75	0,75	16,0	18,9				
	80	0,50	0,50	16,0	16,6	1,84	0,50	1,80	0,52
		0,75	0,75	16,0	20,9				
	100	0,50	0,50	16,0	18,6	2,30	0,40	2,30	0,42
		0,75	0,75	16,0	22,9				
	120	0,50	0,50	16,0	20,6	2,77	0,34	2,75	0,35
		0,75	0,75	16,0	24,9				
	140	0,50	0,50	16,0	22,6	3,23	0,29	3,20	0,30
		0,75	0,75	14,9	26,9				
160	0,50	0,50	16,0	24,6	3,70	0,25	3,70	0,27	
	0,75	0,75	13,9	28,9					
180	0,50	0,50	15,1	26,6	4,16	0,23	4,15	0,24	
	0,75	0,75	13,0	30,9					
200	0,50	0,50	14,1	28,5	4,63	0,20	4,60	0,20	
	0,75	0,75	12,2	32,8					
D2	60	0,50	0,50	16,0	16,0	1,31	0,68	1,30	0,70
		0,75	0,75	16,0	20,4				
	80	0,50	0,50	16,0	18,5	1,76	0,52	1,75	0,54
		0,75	0,75	16,0	22,9				
	100	0,50	0,50	16,0	21,0	2,20	0,42	2,20	0,43
		0,75	0,75	15,8	25,4				
120	0,50	0,50	16,0	23,5	2,64	0,35	2,60	0,37	
	0,75	0,75	14,4	27,9					
140	0,50	0,50	15,4	26,0	3,09	0,30	3,05	0,32	
	0,75	0,75	13,2	30,4					
160	0,50	0,50	14,0	28,5	3,53	0,27	3,50	0,28	
	0,75	0,75	12,2	32,9					

Element thickness d=150 mm, longer versions or other combinations of material thickness on request

\* calculating acc. to EN ISO 6946

\*\* calculating acc. to EN 13162 taking account of the joints acc. to prEN 14 509

## Fire resistance

Building material category A2-s1, d0 to DIN EN 13501-1  
"non combustible"

### Fire resistance category for use as a wall element

Fire resistance class	Laying direction	Max. spacing <sup>1</sup>	Type	Element thickness	P-Nr.
		m		mm	
F30-A	vertikal	≤ 4,00	D2	≥ 60	
		≤ 5,00	D1	≥ 80	
	horizontal	≤ 6,00	D2	≥ 100	
F60-A	vertikal	≤ 4,00	D1	≥ 80	
		≤ 5,00	D2	≥ 80	
	horizontal	≤ 6,00	D2	≥ 120	
F90-A	vertikal	≤ 5,00	D2	≥ 100	1
		≤ 6,00	D2	≥ 120	
	horizontal	≤ 3,20 ≤ 6,00	D2 D2	≥ 100 ≥ 120	
F120-A	vertikal	≤ 5,00	D2	≥ 120	
W90-A	vertikal	≤ 5,00	D2	≥ 80	2
	horizontal	≤ 4,50	D2	≥ 100	
EI 30*	vertikal / horizontal <sup>2)</sup>	≤ 4,00	D2	≥ 60	3
				≥ 80	
				≥ 160	
EI 60*	vertikal / horizontal <sup>2)</sup>	≤ 4,00	D1	≥ 80	4
				≥ 120	
				≥ 160	
EI 90*	vertikal / horizontal <sup>2)</sup>	≤ 4,00	D1	≥ 160	5
				≥ 120	
				≥ 80	

### Fire resistance category for use as a floor element

Fire resistance class	Condition of support / flame impingement conditions	Max. spacing <sup>1</sup>	Type	Element thickness	P-Nr.
		m		mm	
EI 30**	Unsupported floor / flame impingement from below "a ← b"	≤ 4,40	D1	≥ 100	6

\*) Tested according to European standards EN 1363-1 und EN 1364-1, Classification according to DIN EN 13501-2

\*\*) Tested according to European standards EN 1364-2, Classification according to DIN EN 13501-2

1) give attention to static calculation

2) Horizontal direktion in Germany not permitted

#### P-Nr. Test certificate no.

- 1 General test certificate no. Nr. P-3545/2430-MPA BS
- 2 General test certificate no. Nr. P-3544/2420-MPA BS
- 3 3275 / 8119
- 4 9477A
- 5 PB III / B-03-036
- 6 PB III / B-02-237

### Sound insulation

Sound reduction index RW = 29 dB.

### Air permeability of joints

For horizontally and vertically laid isorock®

a = 0 m³/h m daPa1,0

(as per test reports no. P6-307/1999 and no. P6-306/1999)

### Material

Cover sheets:	Steel grade S 320 GD+ZA255 according to DIN 10214 alloy-galvanised GALFAN®
Insulating core:	Non-combustible mineral fibre, building material class A1 as per DIN 4102-1

### Approval

General approval no. Z-10.4-235 issued by the Building Authorities

Finish of cover shells	Element side
M = micro-profiled V = V-profiled L = slightly profiled E = flat	outside
L = slightly profiled E = flat	inside

### Ref.no. for ordering

example: isorock® ML 80 / 0.60 - D1

isorock®	M	L	80	/	0,60	-	D1
	Outer shell type	Inner shell type	Element thickness		Thickness of cover shells		Type
	M = micro-profiled	L = slightly profiled	80 mm		0,60 mm		D1

### ThyssenKrupp Hoesch Bausysteme GmbH

Hammerstraße 11

57223 Kreuztal, Germany

Phone ++ 49 / 2732 / 599 – 1221

Fax ++ 49 / 2732 / 599 – 1219

e-mail export.tks-bau@thyssenkrupp.com

Internet www.tks-bau.com